

New Prospect

+/- 92.19 Acre Tract (North) and +/- 56.00 Acre Tract (South)
Rusk County, Texas
Location Map

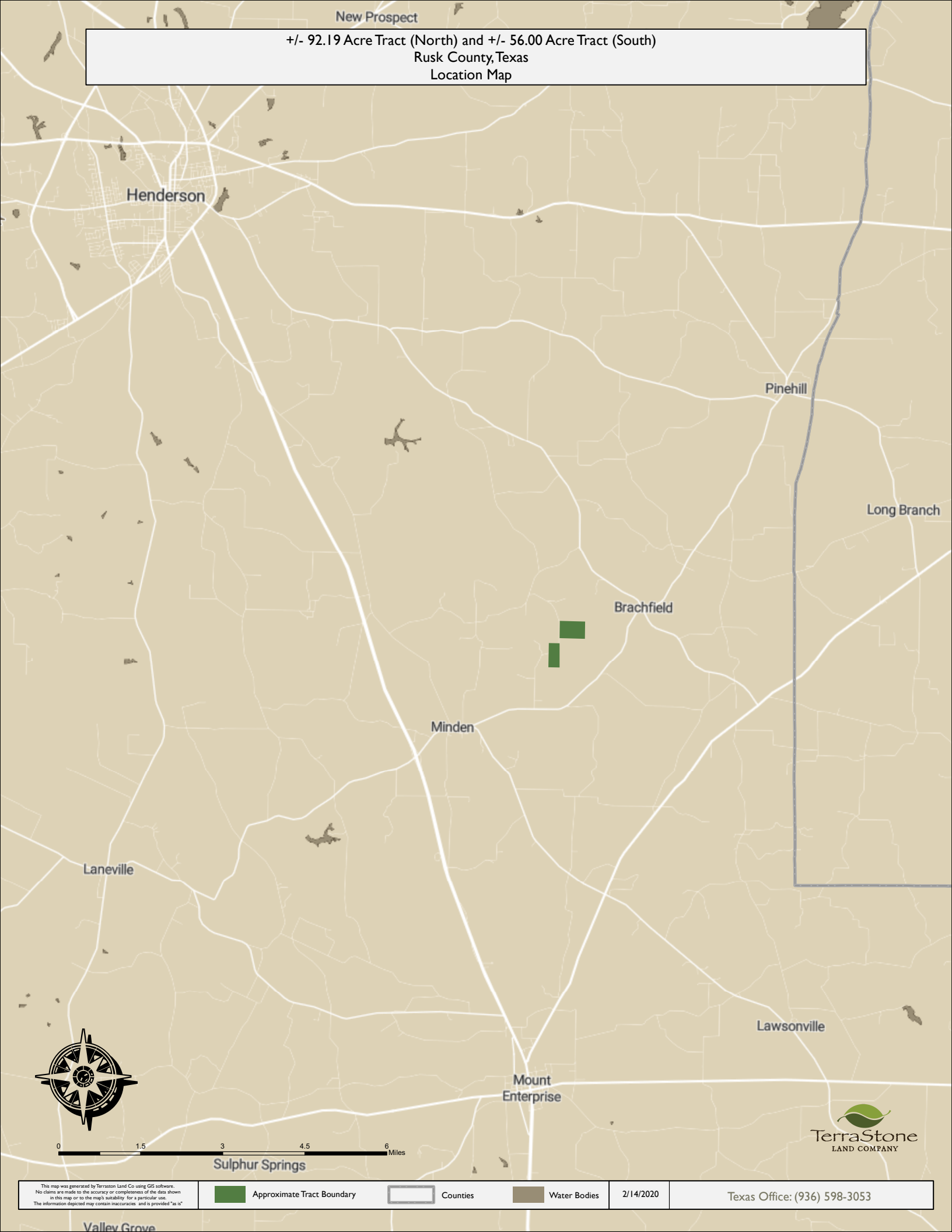

Henderson

Pinehill

Long Branch

Brachfield

Minden

Laneville

Lawsonville

Mount
Enterprise



0 1.5 3 4.5 6 Miles

Sulphur Springs



This map was generated by TerraStone Land Co using GIS software.
No claims are made to the accuracy or completeness of the data shown
in this map or to the map's suitability for a particular use.
The information depicted may contain inaccuracies, and is provided "as is"

 Approximate Tract Boundary

 Counties

 Water Bodies

2/14/2020

Texas Office: (936) 598-3053

Valley Grove