

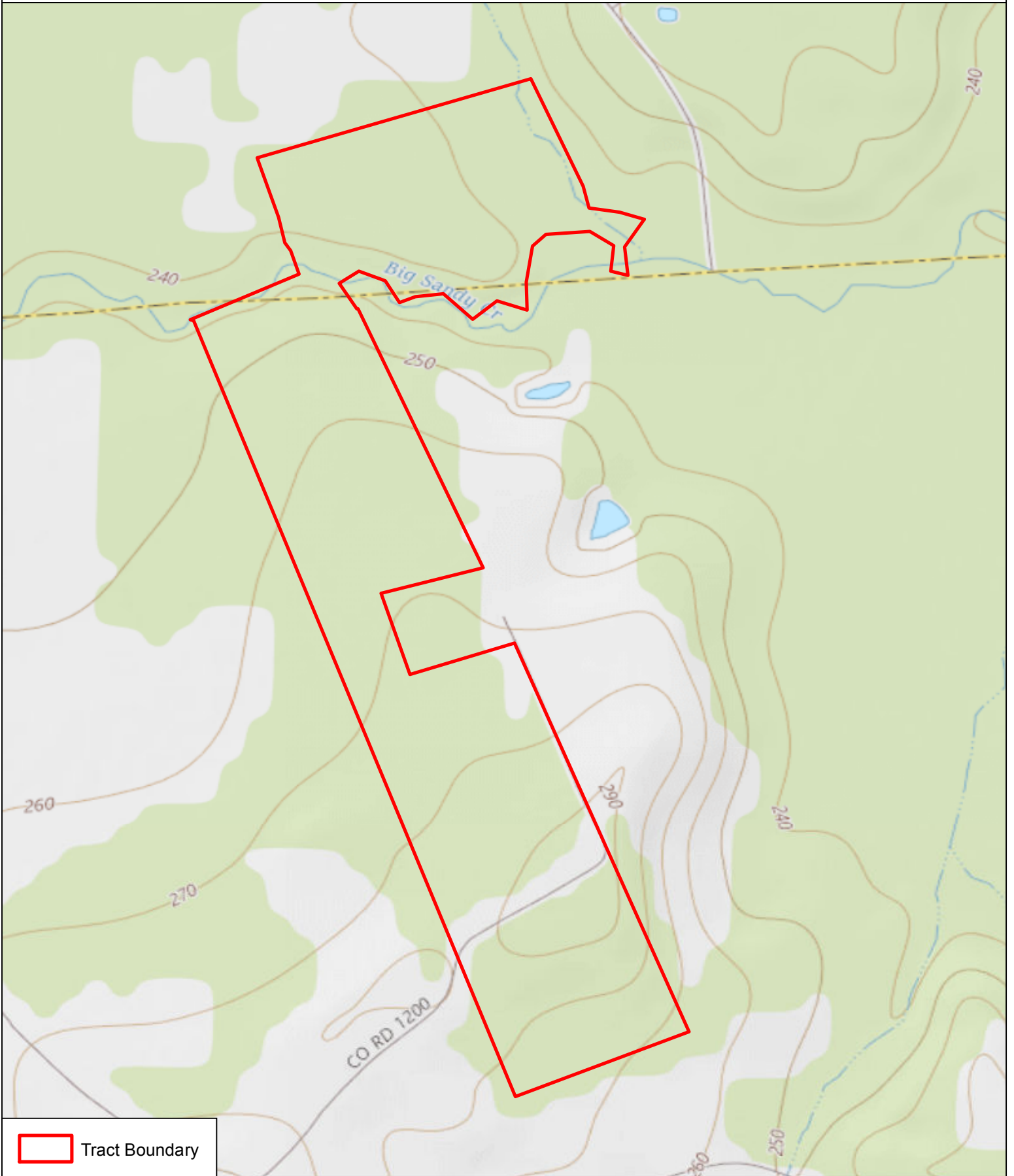

Scrappin Valley: +/- 68 acres
Newton and Sabine County, Texas



 Tract Boundary



12/13/2017
Imagery: ESRI

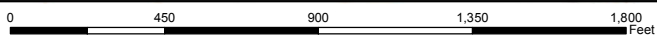

1 Inch = 562 Feet

No claims are made to the accuracy or completeness of the data shown in this map or to the map's suitability for a particular use. The information depicted may contain inaccuracies and is provided "as is".

